

Seal Here With Staple or Tape

Fold Here

**BUSINESS REPLY SERVICE
PERMIT NO. 06797**



SHINETOWN TELECOM (S) PTE LTD
27A Tanjong Pagar Road
Singapore 088450

Postage will be paid by addressee. For posting in Singapore only

Fold Here

How to use the Business Reply Envelope (BRE)

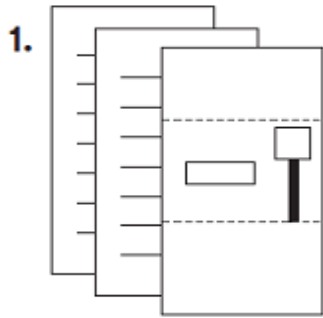

1. Place application form with the BRE on top.

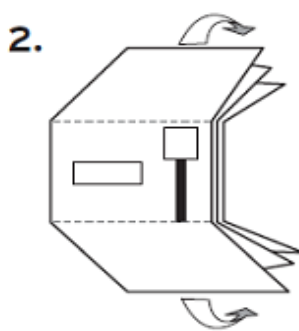

2. Fold inwards along the dotted lines indicated.

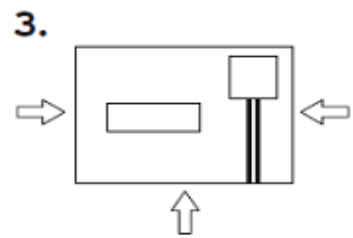

3. Seal along the edges with staple

Seal Here With Staple or Tape

Seal Here With Staple or Tape

Seal Here With Staple or Tape